

Specifications

Current Rating :	1.0 Ampere
Insulation Resistance :	1000 MΩ Min
Dielectric Withstanding :	300V AC
Contact Resistance :	20 mΩ Max
Operating Temperature :	-40°C to +105°C

Materials

Contact Material :	Phosphor Bronze
Insulation Material :	High Temperature Thermoplastic, 94V-0 LCP

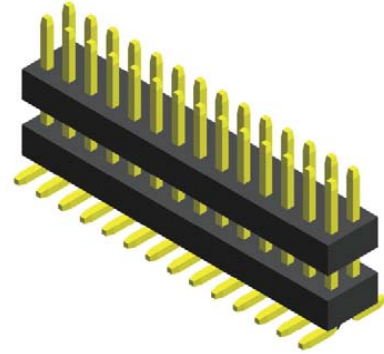

Mating with



CFB3N211

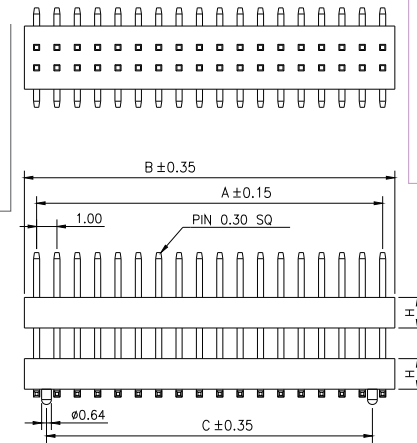
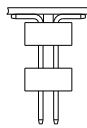

Recommended P.C.Board Layout

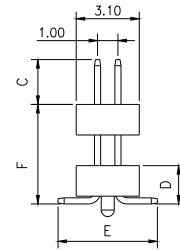
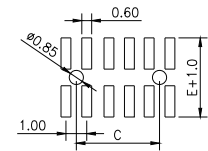

No. of Pins/Row	Dimension Information			No. of Pins/Row	Dimension Information			No. of Pins/Row	Dimension Information			No. of Pins/Row	Dimension Information		
	A	B	C		A	B	C		A	B	C		A	B	C
03	2.00	3.20	1.00	11	10.00	11.20	9.00	21	20.00	21.20	19.00	31	30.00	31.20	29.00
04	3.00	4.20	2.00	12	11.00	12.20	10.00	22	21.00	22.20	20.00	32	31.00	32.20	30.00
05	4.00	5.20	3.00	13	12.00	13.20	11.00	23	22.00	23.20	21.00	33	32.00	33.20	31.00
06	5.00	6.20	4.00	14	13.00	14.20	12.00	24	23.00	24.20	22.00	34	33.00	34.20	32.00
07	6.00	7.20	5.00	15	14.00	15.20	13.00	25	24.00	25.20	23.00	35	34.00	35.20	33.00
08	7.00	8.20	6.00	16	15.00	16.20	14.00	26	25.00	26.20	24.00	36	35.00	36.20	34.00
09	8.00	9.20	7.00	17	16.00	17.20	15.00	27	26.00	27.20	25.00	37	36.00	37.20	35.00
10	9.00	10.20	8.00	18	17.00	18.20	16.00	28	27.00	28.20	26.00	38	37.00	38.20	36.00
				19	18.00	19.20	17.00	29	28.00	29.20	27.00	39	38.00	39.20	37.00
				20	19.00	20.20	18.00	30	29.00	30.20	28.00	40	39.00	40.20	38.00

Ordering Codes

C MA3E205 - XX

No Of Pins Per Row
03 - 40

Plating Code
03 - Tin
06 - Gold Flash

XX

Material Code
C - LCP

X

XXX

Pin Length (C/D)

004 : C=1.90/D=1.30/E=5.20/F=2.30

X

Colour Code
N - Black

X

Post
W - W/O Post

A

Packing Code
C - Tube

X

For special length requirement
Please contact our sales personnel

Due to technical progress, all designs, specifications and components are subject to change without notice.